



BPX™ BPDW Double-Wall Brazed Plate Heat Exchangers

HIGH PERFORMANCE. REDEFINED.

BPX™ BPDW Double-Wall*

BPX™ BPDW Double-Wall brazed plate heat exchangers offer the highest level of leak protection, safety, thermal efficiency and durability in a compact, low cost unit. Bell & Gossett's advanced lean manufacturing process provides fast deliveries with maximum design flexibility.

BPX™ BPDW Double-Wall* Provides:

- True double-wall construction, including port regions
- Double-wall plate design with unique air vent leak paths
- Complete peripheral braze for additional strength
- Four dedicated leak ports for quick and easy leak detection (A)
- Excellent performance for domestic water applications
- Dependable protection of fresh water streams for cooling of oils and refrigerants.

Brazing Material

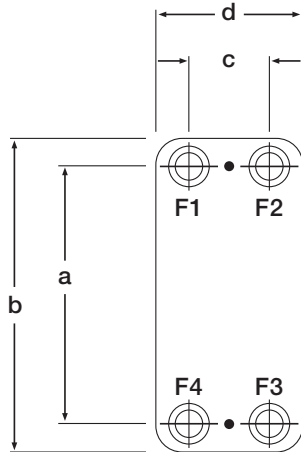
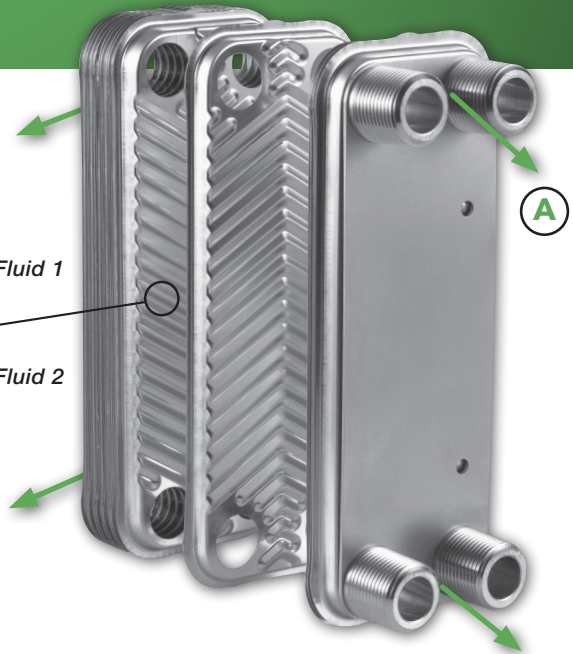
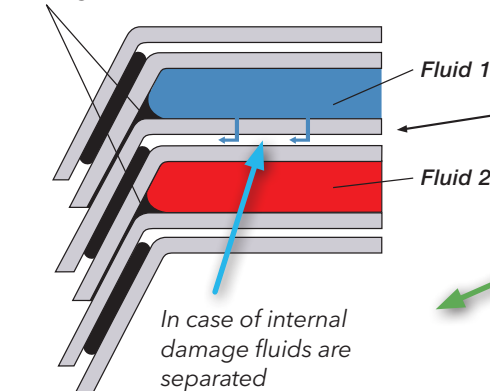

MODEL TYPE	A	B	C	D
BPDW410	9.84	12.2	1.97	4.4
BPDW415	18.35	20.7	1.97	4.4
BPDW422	20.43	24.5	3.62	7.5

Mechanical Design

Design Pressure (higher pressures available) 435 psig
 Maximum Design Temperature 450°F
 Minimum Design Temperature -310°F
 Plate Material 316L
 Braze Material Copper

Approvals & Certifications

- ASME Section VIII Div. 1 U-1 Stamp Available
- CRN, UL, CE/PED, NSF372, UPC

We value your feedback. Please take our 3 question survey at bellgossett.com/survey to let us know how we are doing.



Xylem Inc.
 175 Standard Parkway
 Cheektowaga, NY 14227
 Phone: (800) 447-7700
 FAX: (716) 862-4176
www.xylem.com/bellgossett

Xylem and Bell & Gossett are registered trademarks of Xylem Inc. or one of its subsidiaries. All other trademarks or registered trademarks are property of their respective owners.
 © 2023 Xylem Inc. C-320C August 2023

To learn more about heat exchangers:

